

# OPERA KÄLLARENS FESTVÅNINGAR

## Konferenskapacitet / Seating Capacity

### OPERATERRASSEN:

Yta / Area 380 m<sup>2</sup>

Lunch, middag / Luncheon, dinner: 300

Cocktail: 350

Konferens / Conference

Parkett / Theatre style: 150

Skolsittning / Classroom seating: 80\*

”Öar” / Round tables: 80

### ROTUNDAN:

Yta / Area 320 m<sup>2</sup>

Lunch, middag / Luncheon, dinner: 324

Cocktail: 350

Konferens / Conference

Parkett / Theatre style: 300

Skolsittning / Classroom seating: 200\*

”Öar” / Round tables: 200

\* = Hyra av bord tillkommer /  
Rent of tables not included

### OPERATERRASSEN + ROTUNDAN:

Lunch, middag / Luncheon, dinner: 600

Cocktail: 700

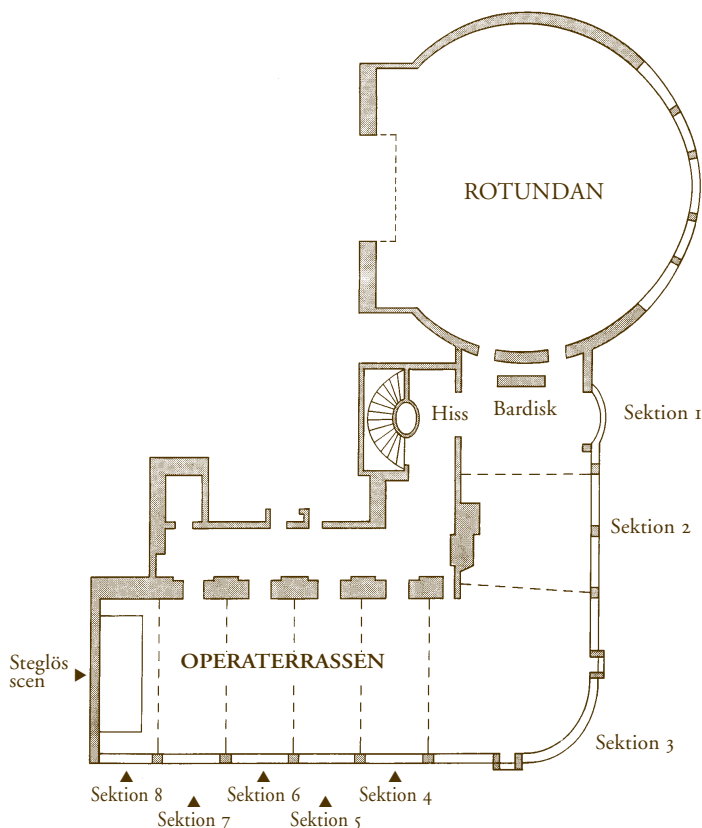

### ENTRESOLVÅNINGEN

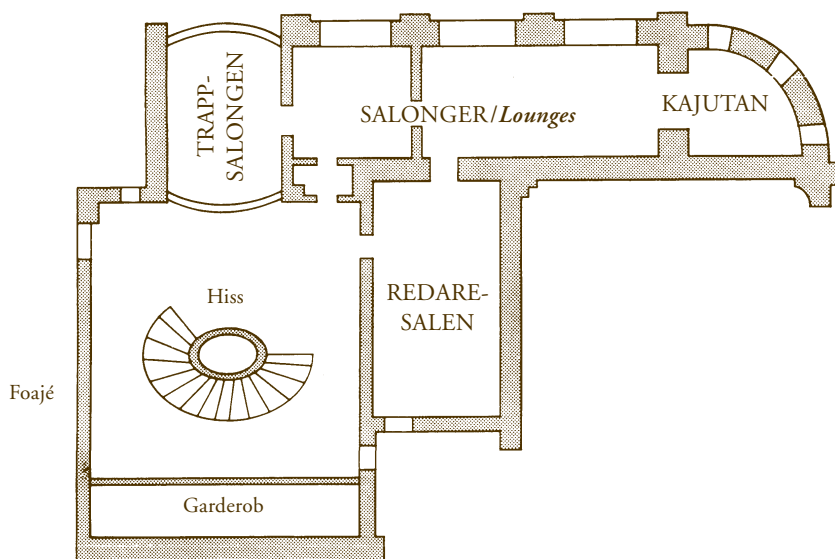

### REDARESALEN:

Yta / Area 35 m<sup>2</sup>

Lunch, middag / Luncheon, dinner: 21/36

Konferens / Conference

Parkett / Theatre style: 30

Styrelsesittning / Board meeting: 21

### TRAPPSALONGEN:

Yta / Area 24 m<sup>2</sup>

Lunch, middag / Luncheon, dinner: 16

Parkett / Theatre style: 18

Styrelsesittning / Board meeting: 16

### SALONGEN & KAJUTAN:

Yta / Area 40 m<sup>2</sup>

Lunch, middag / Luncheon, dinner: 22/28

Parkett / Theatre style: 30

Styrelsesittning / Board meeting: 22

### HELA ENTRESOLVÅNINGEN / THE ENTIRE ENTRESOL:

Cocktail: 50